

# VARI-FLEX®



The Vari-Flex provides an exclusive combination of comfort and dynamics.

The Vari-Flex is light-weight, easy to assemble and has a slender profile which makes it easy to cosmetically cover.

For users it ensures the highest levels of confidence and security. Offering natural gait with less fatigue and ultimately less strain on the lower back and sound side, it is the ideal foot for any activity.

Unity for Vari-Flex is an ultra lightweight foot and elevated vacuum suspension system designed to stabilize volume fluctuations and improve socket fit. For the moderately to high active user who prefers a simple, robust and lightweight prosthesis, Unity for Vari-Flex and Seal-In technology combined provide secure suspension, volume management and great foot dynamics without the restricting effect of an external suspension sleeve.



ÖSSUR FEET

User Information	
Amputation Level:	Transfemoral and Transtibial
Impact Level:	Low to High
Maximum Patient Weight:	166kg (365lbs)

PROPORTIONAL RESPONSE	CARBON-X® ACTIVE HEEL	FULL LENGTH TOE LEVER	ACTIVE TIBIAL PROGRESSION
SPLIT TOE	WATERPROOF*	WEATHERPROOF**	

\* Vari-Flex with carbon tube  
 \*\* Vari-Flex with pyramid

Foot information	
Categories:	1-9
Sizes:	22-30
Weight of Foot: (Size 27)	594g (21oz) w/ Pyramid and Foot Cover
Build Height: (Size 27)	170mm (6 3/4") w/ Pyramid and Foot Cover
Heel Height:	10mm and 19mm (3/8" and 3/4")
Adapter Options:	Fixed Male Pyramid, Quick-Align™ Male Pyramid or Carbon Tube

Unity System Information	
Maximum Vacuum:	-23inHg (-600mmHg)
Normal Operating Pressure:	-16-20 inHg
Added System Weight:	130g w/ Pump, Socket Valve and Tube

# VARI-FLEX®

## ORDERING INFORMATION

FOR COMPLETE FOOT WITH MALE PYRAMID

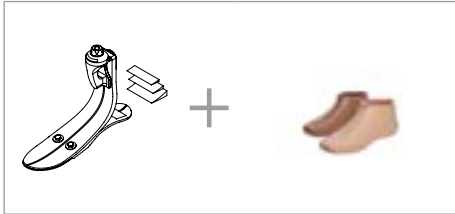

FOR COMPLETE FOOT WITH QUICK-ALIGN™

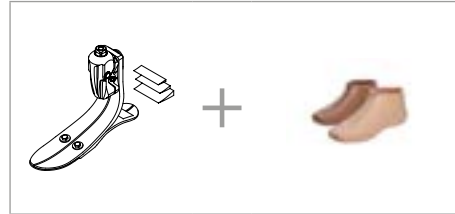

Note. Quick-Align maximum patient weight: 125kg (275lbs)

FOR COMPLETE FOOT WITH CARBON FIBER TUBE

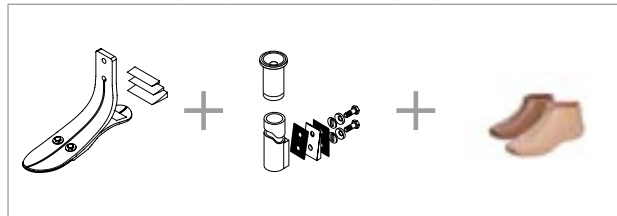

Unity can be ordered with Vari-Flex. Please select the appropriate Unity Pump Module kit according to foot module size when placing an order and Unity will come preassembled on the foot. For extra convenience and system compatibility, Unity Valve Kits are highly recommended as a means of connecting to the socket.

For liner selection and item numbers please refer to Icross Seal-In V and Seal-In® X TF pages.

FOR COMPLETE FOOT WITH UNITY

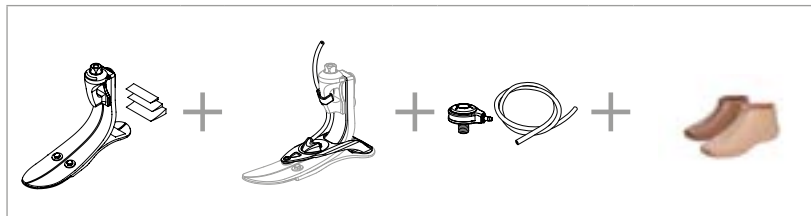

## CATEGORY SELECTION CHART

Weight kg	45-52	53-59	60-68	69-77	78-88	89-100	101-116	117-130	131-147	148-166
Weight lbs	99-115	116-130	131-150	151-170	171-194	195-221	222-256	257-287	288-324	325-365
Low Impact Level	1	1	2	3	4	5	6	7	8	9
Moderate Impact Level	1	2	3	4	5	6	7	8	9	N/A
High Impact Level	2	3	4	5	6	7	8	9	N/A	N/A

# VARI-FLEX®

## CLEARANCE

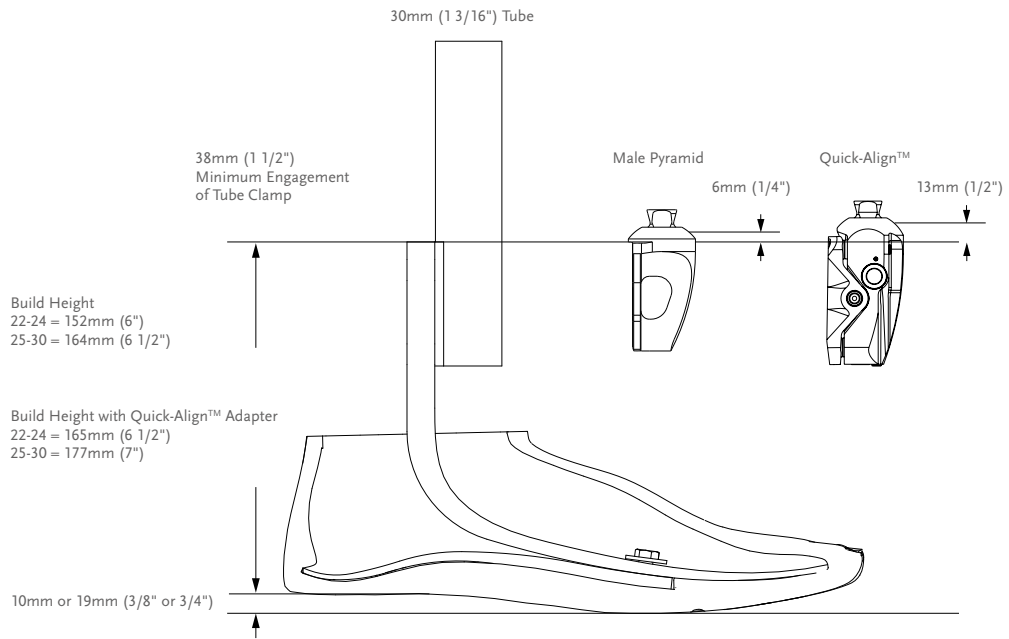

ÖSSUR FEET

## CLEARANCE WITH UNITY

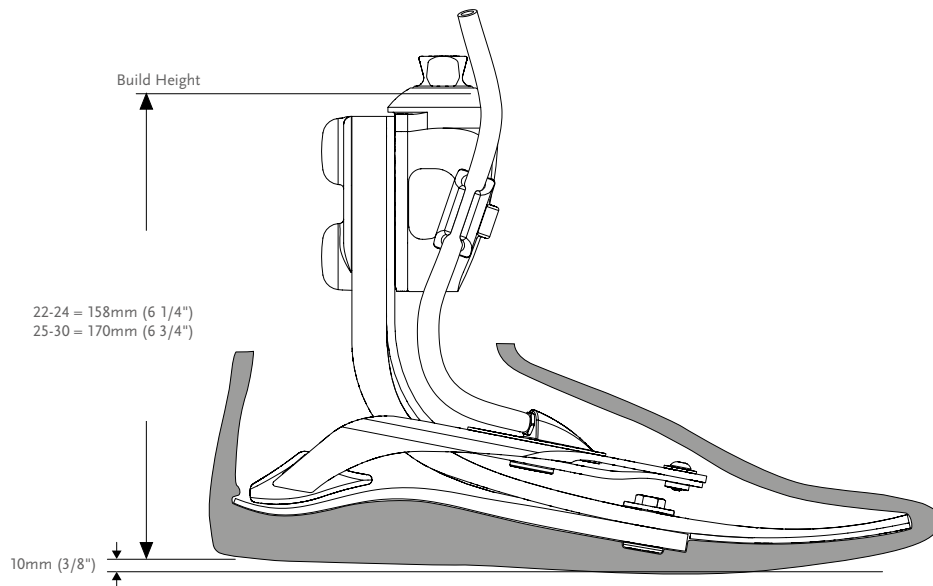

# VARI-FLEX®

## KITS

### VARI-FLEX MALE PYRAMID OPTION

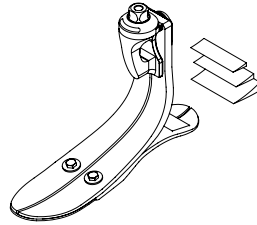
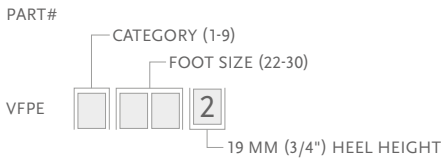
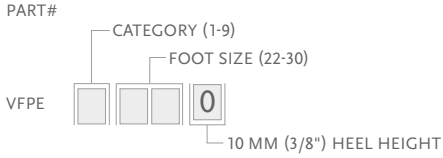

Note: Solid toe, low and high heel are special orders.

### VARI-FLEX WITHOUT ADAPTER

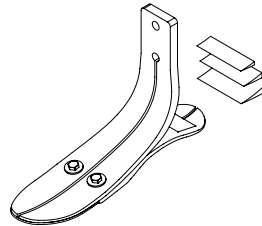
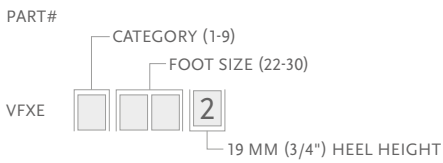
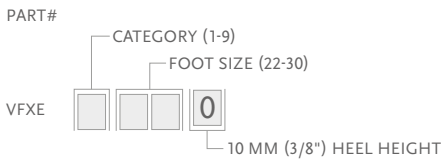

Note: Solid toe, low and high heel are special orders.

### VARI-FLEX WITH QUICK-ALIGN™

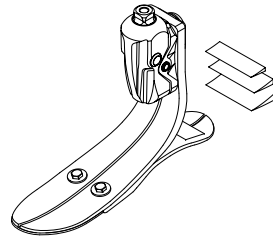
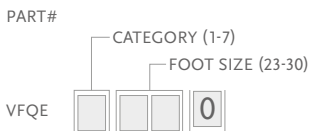

# VARI-FLEX®

## MALE ADAPTERS

### BOLT-ON MALE PYRAMID ADAPTER

Select according to category of foot module being utilized.

Part#	Cat.	Weight	
FFC2210001	1-6	175g	6.2oz
FFC2210002	7-9	205g	7.2oz

Includes:

- Pyramid
- Hardware (M8 or M10 bolts)
- Plastic Bolt Cap
- Loctite

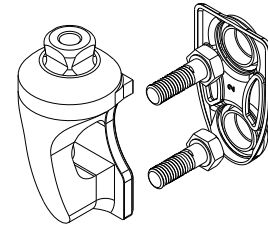

### ATTACHMENT BOLTS FOR PYRAMID

Part#	Cat.	Size	Length	
CM130234	1-6	M8	35mm	1 3/8"
CM130223	7-8	M10	35mm	1 3/8"

### QUICK-ALIGN™ ADAPTER FOR VARI-FLEX

Manually adjustable heel height adapter that provides 8° of flexion, which translates to 30mm heel height range with a size 25 foot.

Heel height changes are easily made by the user, with an unlock button to enable adjustments and a lock button to fix the position again.

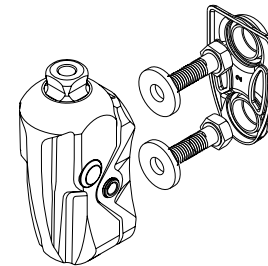

With New Foot Module, Part#	Cat.	Weight	
QAP12551	1-4	384g	13.5oz
QAP12552	5-6	384g	13.5oz
QAP12553	7	384g	13.5oz
Retrofit Kit for Existing Foot Module, Part#	Cat.	Weight	
QAP12501	1-4	384g	13.5oz
QAP12502	5-6	384g	13.5oz
QAP12503	7	384g	13.5oz

Includes:

- Hardware (M8 and M10 bolts)
- Washers
- Plastic bolt cap

# VARI-FLEX®

## TUBE KITS

### 30MM (1 3/16") CARBON FIBER TUBE KIT

Choose according to size and category of the foot module utilized.

Part#	Cat.	Size	Length		Hole Spacing		Weight	
VFX00003	1-6	22-30	229mm	9"	38mm	1 1/2"	216g	7.3oz
VFX00004	7-9	22-30	229mm	9"	38mm	1 1/2"	275g	9.7oz
VFX00006	1-6	22-30	381mm	15"	38mm	1 1/2"	293g	10.3oz
VFX00007	7-9	22-30	381mm	15"	38mm	1 1/2"	369g	13oz

Includes:

- Alignment Wedges
- Tube
- Spherical Washers
- Attachment Bolts and Hardware ( 5/16" UNF)
- Friction Pads
- Tube Insert (Cat.7-9)

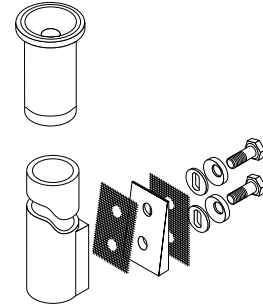

### TUBE INSERT FOR CATEGORY 7-9; 30MM (1 3/16")

Tube inserts provide the structural integrity necessary for higher category tubes.

Part#	Diameter		Weight	
A-718009	30mm	1 3/16"	18g	0.63oz

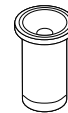

### ALIGNMENT WEDGES FOR TUBE KIT (2 DEGREES AND 4 DEGREES)

Placed between the pylon and foot module, alignment wedges allow for plantarflexion and dorsiflexion of the foot without the use of modular components.

Part#	Cat.
CM150041	1-6
CM150042	7-9

Includes:

- Wedges
- Friction Pad
- Loctite

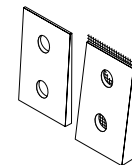

### ATTACHMENT BOLTS FOR 30MM (1 3/16") TUBE

Part#	Cat.	Size	Length
CM130219	1-6	5/16" x 24	1 3/4"
CM130213	7-9	3/8" x 24	1 3/4"

# VARI-FLEX®

## COMPONENTS

### HEEL WEDGE KIT

For adjustment of heel stiffness and roll-over characteristics.

Part#	Foot Size
CM150006	22-27
CM150009	28-30

Includes:

- 3 Wedges
- Adhesive

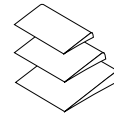

### HEEL DIVIDER

Heel dividers act to separate the edges of a split heel to reduce wear and noise between the composite elements.

Part#	Description
CM140003	Heel Divider

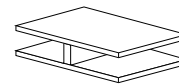

### LOCTITE 410 BLACK

Part#	Description
CM160016	Loctite 410 black

## TOOLS

### KIT TEMPORARY SLOTTED WEDGE, CAT 1-9

Use for initial dynamic alignment of the prosthesis. These wedges are removed and replaced with definitive alignment wedges.

Part#	Cat.
CM100204	ALL

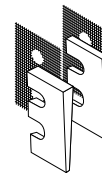

### 30MM (1 3/16") ALIGNMENT FITTING TOOL KIT

Used in conjunction with pre-cut carbon or Aluminum pylons to establish height of the prosthesis and alignment. Once height and alignment are established, the fixture can be replaced with a standard Flex-Foot® carbon fiber tube.

Part#	Cat.
VFX00008	ALL

Includes:

- Attachment Hardware
- Alignment Tool

Note: Alignment tool is solely meant for alignment purposes not definitive use.

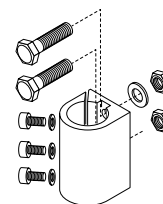

# VARI-FLEX®

## UNITY

### UNITY KITS

Picture	Part#	Description	Applicable Foot Kits
1	UVF0024	Unity Pump Module VFX 22-24	Vari-Flex Std Size 22-24
1	UVF0027	Unity Pump Module VFX 25-27	Vari-Flex Std Size 25-27
1	UVF0030	Unity Pump Module VFX 28-30	Vari-Flex Std Size 28-30
2	UTT0001	Unity TT Valve Kit	All
3	UTF0001	Unity TF Valve Kit	All
4	UTF0006	Unity TF Tube Kit	All
5	L-5446XX	Icelock 544 Kit	All

### UNITY SPARE COMPONENTS

Part#	Description
UVF00021	Unity VF Components, 22-24
UVF00022	Unity VF Components, 25-30

Includes:

- Membrane
- Check valves
- Barb fittings
- Tube
- Tube fastener
- Heel pad

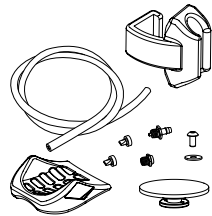

### FOOT KITS APPLICABLE WITH UNITY

#### VARI-FLEX MALE PYRAMID OPTION

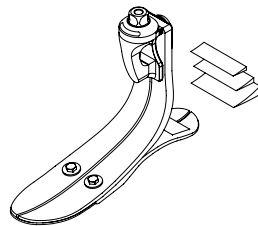
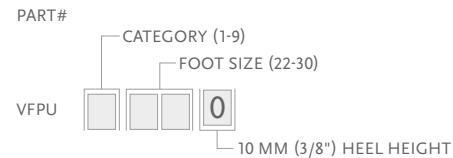

# VARI-FLEX®

## COSMETIC FINISHING

### FOOT COVER KIT, BEIGE AND BROWN\*

PART#

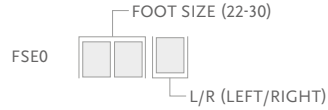

Includes:

- Foot Cover
- Flex-Foot Sock
- Foot Cover Attachment

\*Please specify when ordering brown covers, add "BR" to the end of the part number.

### FLEX-FOOT SOCKS

Used to cover the composite foot module to protect the foot and eliminate noise between foot module and foot shell.

Part#	Description	Size	Color
FSEL60001	Black Sock Small 1 pc	22-25	Black
FSEL60002	Black Sock Large 1 pc	26-30	Black
FSEL60001-15	Black Sock Small 15 pc	22-25	Black
FSEL60002-15	Black Sock Large 15 pc	26-30	Black



# VARI-FLEX®

## DIAGRAM

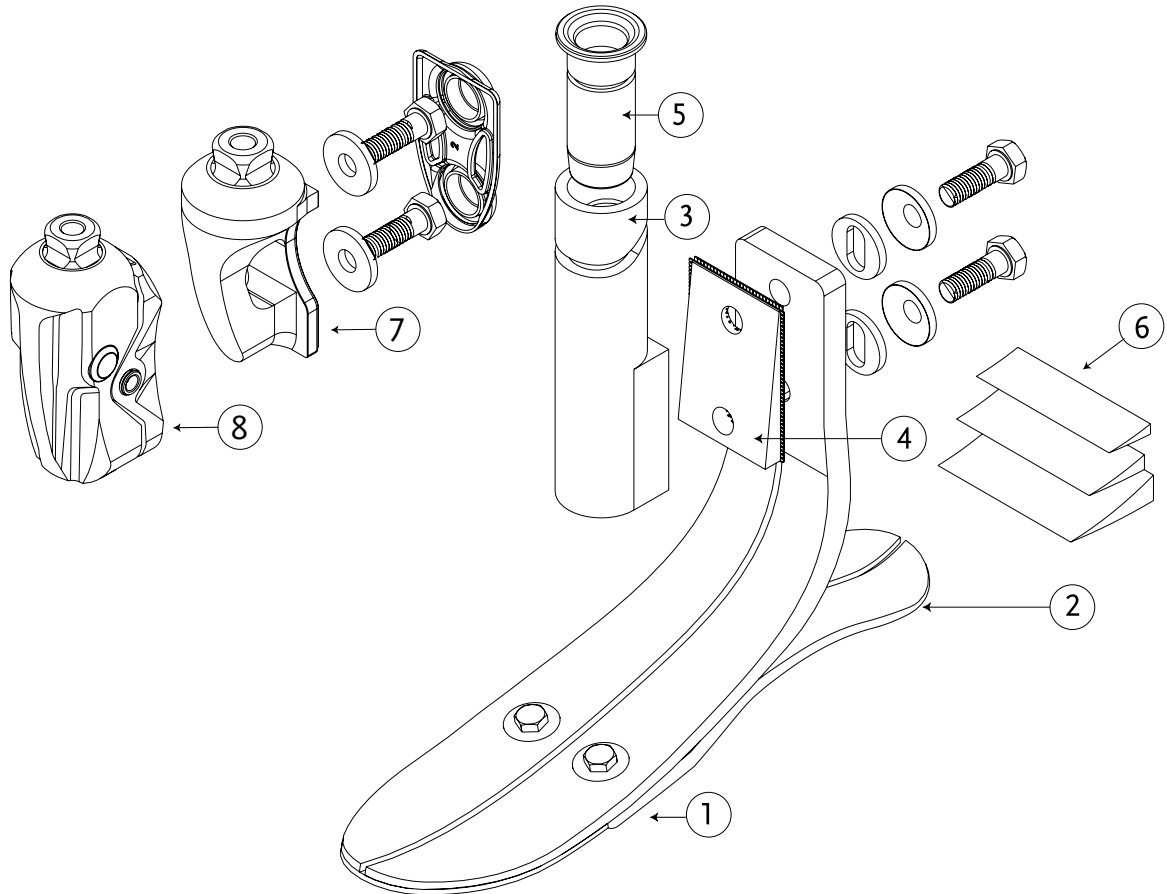

	Description
1.	Foot Module
2.	Heel
3.	30mm Carbon Fiber Tube Kit
4.	Alignment Wedges For Tube Kit
5.	Tube Insert
6.	Heel Wedge
7.	Bolt-On Male Pyramid Adapter
8.	Quick-Align™ Adapter